



APPLICATIONS SPECIFICATION

RAM SERIES 200 STEEL WHARF PILE PROTECTION SYSTEM

SURFACE PREPARATION

All loose material including rust, marine growth, paint must be removed by cleaning using methods such as a wire brush, chipping hammers, mechanical wire brushes or high pressure water blasting may also be utilised.

All sharp objects that may cause perforations must be removed.

PRIMING

RAM Marine Primer is capable of being applied above and below water.

RAM Marine Primer should firstly be applied to achieve a thin film thickness to the surface area with a gloved hand, cloth or roller, at a spreading rate of 1.0kg/m².

RAM Marine Primer is applied to passivate the steel and to act as a bonding agent for the tape. All cavities should be filled whilst the RAM Marine Primer is applied in a circular fashion.

It may be helpful to use a scouring pad on the substrate immediately prior to

TAPE WRAPPING

Apply tape ensuring firm tension and then smooth down by hand to exclude any water.

Starting from the top or the bottom of the pile apply RAM Marine Tape with a nominal 55% overlap to achieve a double thickness of tape.

On each new roll of tape, overlap the new roll on previous by a minimum 150mm.

OUTERSHIELD

Wrap the pre cut RAM Series Jacket circumferentially around the pile and align the stiffeners so the holes are opposite each other. The fastening section should be facing away from the strongest wave action.

FASTENING OF THE JACKET

Using the 316 stainless steel threaded rod and nuts provided, fasten the jacket initially by bolting one bottom, middle and top through the pre drilled holes.

Then proceed to fasten remaining predrilled points. Ensure all the nuts are tensioned correctly,(preferably by a pneumatic wrench to a torque of 30kg/m) so that the jacket remains firmly in place. At this stage if any temporary strapping used to hold jacket in place may be removed.

Ensure the second locking nut is used on both sides of the threaded rod with approximately equal amounts of thread protruding once fastened

The fastening line should ideally face in the opposite direction from either the normal river flow or strongest tidal action.

FINAL INSPECTION

The final inspection should ensure the jacket is correctly positioned on the pile. Ensure all fastenings are in place and the correct tension has been used.

RAM Series 200 SYSTEM

Recommended installation method.

Concrete

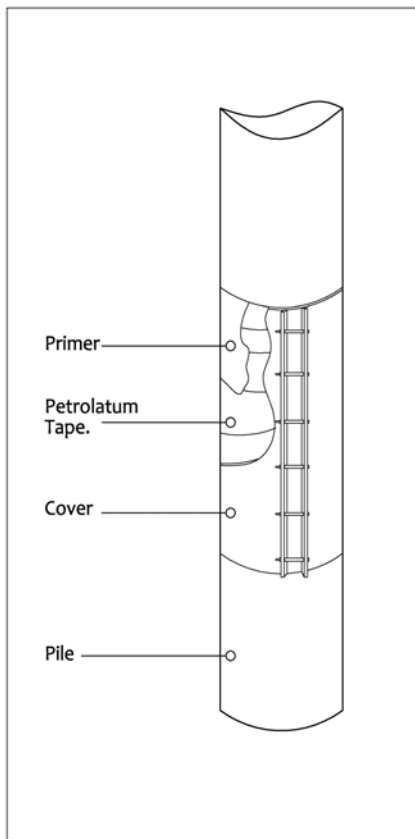
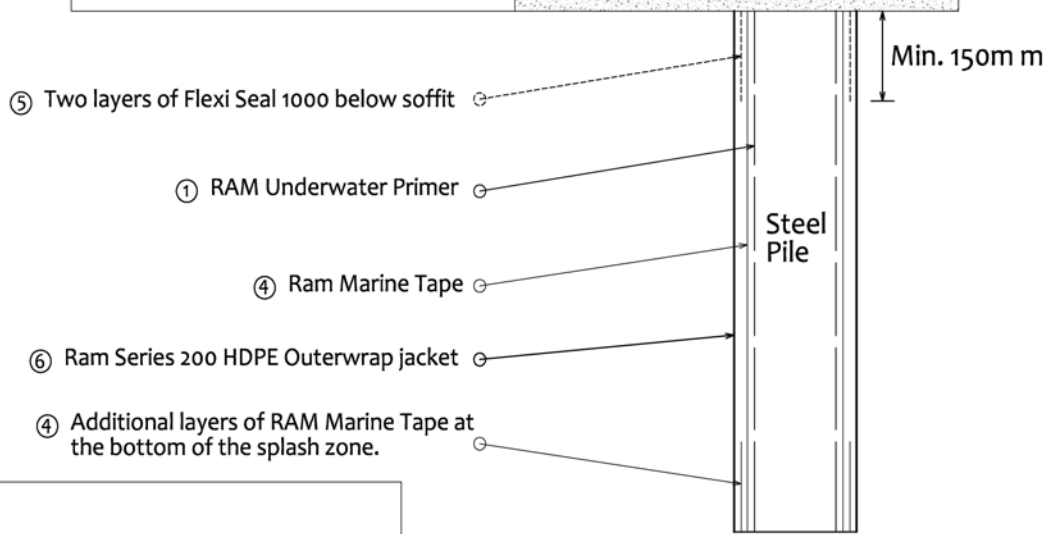

INSTALLATION PROCEDURE.

- 1- Clean the steel pile surface in accordance with SSPC-SP2 or SP3.
- 2- Hand apply a layer of RAM UNDERWATER PRIMER to steel pile surface.
- 3- Use RAM MASTIC to fill badly corroded and pitted surfaces if necessary.
- 4- Apply RAM Marine Tape spirally at 55% overlap from the bottom to top of splash zone, with additional tape applied at the bottom most of splash zone to enhance support to jacket.
- 5- Apply two layers of Flexi seal 1000 at min. 150mm below the concrete soffit.
- 6- Outerwrap with RAM Series 200 HDPE jacket and secure with bolted system.



AUSTRALASIAN INDUSTRIAL WRAPPINGS AND COATINGS
UNIT 10 , 7 LYN PARADE PRESTONS 2171 NSW AUSTRALIA

TEL : 02 9608 8111

FAX : 02 8783 7055

EMAIL: enquiries@aiwc.com.au

WEB: www.aiwc.com.au